

MONTERINGSMANUAL FÖR KRISPOL GARAGEPORT

LÅGLYFT. E-skensystem med dragfjädrar

E-skensystem kräver bara 120 mm ovan för porthålet



QUALITY BY  KRISPOL



MONTERINGSSATS/KOMPONENTER

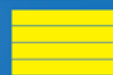
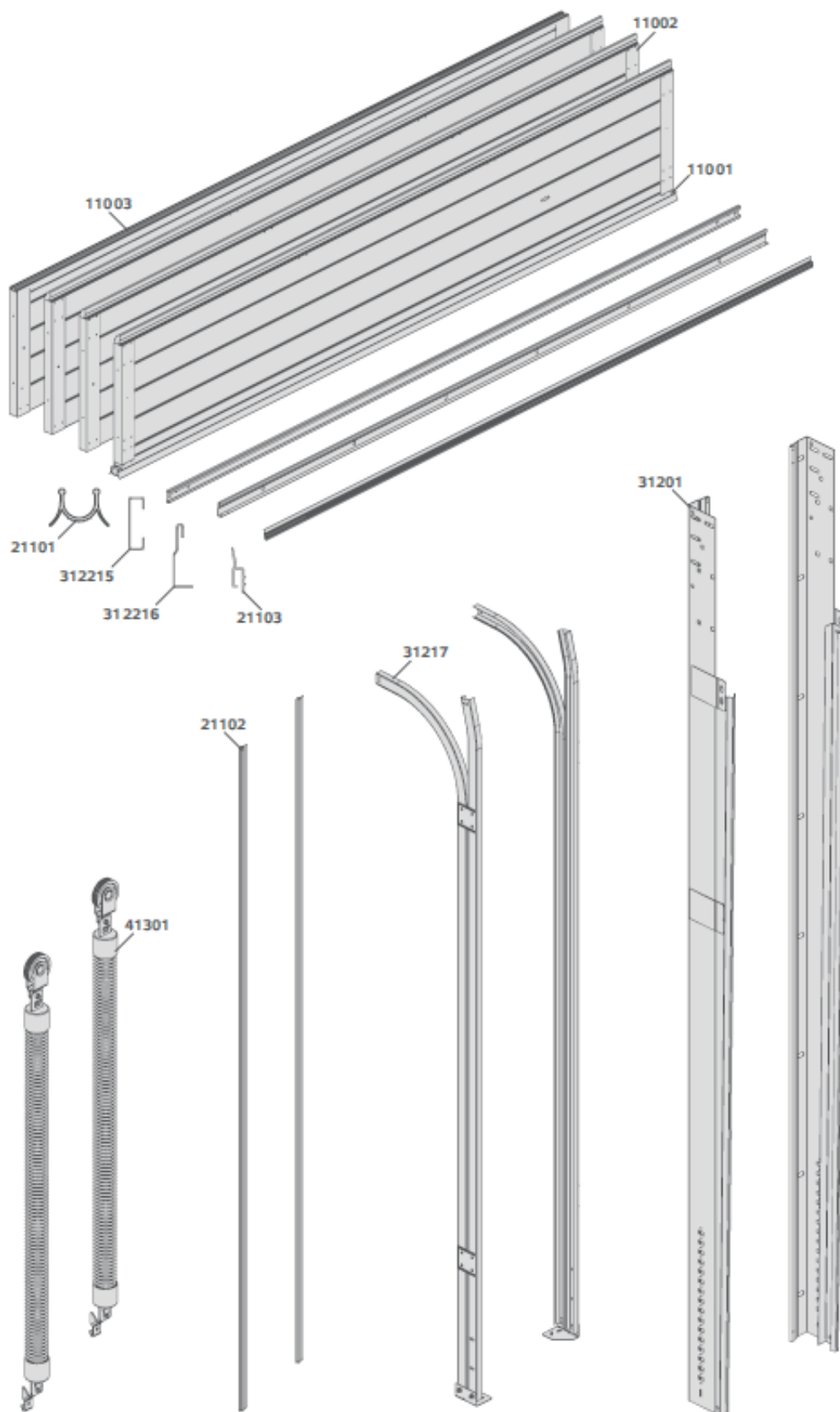

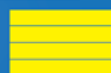
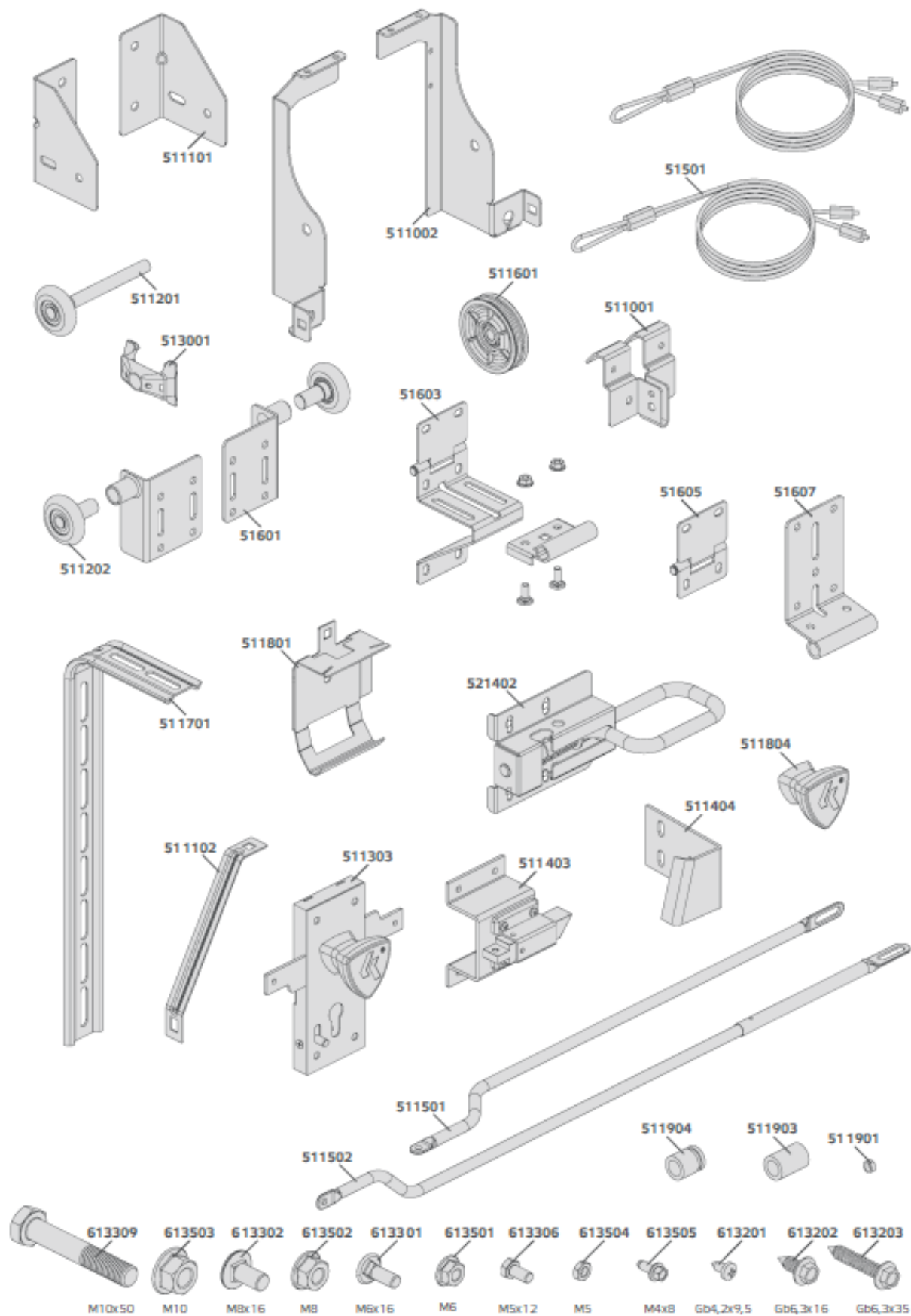

**1 - SEKTION**

nedre sektion med beslag	11001
mellansektion	11002
övre sektion	11003

2 - TÄTNINGAR

tätning till nedre sektion	21101
tätningar till vertikala profiler	21102
tätning till tröskellist	21103

3 - LEDGÅNGAR

vertikala profiler	31201
horisontala ledgångar	31217
monteringsribba	312215
tröskellist	312216

4 - FJÄDER

en dragfjäder	41301
---------------	-------

5 - OBJEKT

linor (par)	51501
konsol	511002
mellanliggande rullar till linor	511601
bakre stöd (par)	511101
uppsättningar av montering	511701/51180:
förstärkning av monteringsats	511102
sidogångjärn med infatting	51603
mittgangjärn	51605
övre gangjärn (par) E	51601
kort rulle	511202
nedre gångjärn (par)	51607
lång rulle	511201
cylinderlas	511303
boltlås	511403
låsbul	511404
regel	521402
standard låsstång	511501
teleskop låsstång	511502
handtag	511804
distanshylsa	511901
distanshylsa 17 mm	511903
distanshylsa 19 mm	511904

6 - SKRUVAR, STOPPSKRUVAR & MUTTRAR

skruvar (M10x50)	613309
muttrar (M10)	613503
skruvar (M8x16)	613302
muttrar (M8)	613502
skruvar (M6x16)	613301
muttrar (M6)	613501
skruvar (M5x12)	613306
muttrar (M5)	613504
skruvar M4x8	613305
stoppskruvar (6,3x16)	613202
stoppskruvar (6,3x35)	613203
stoppskruvar (4,2x9,5)	613201

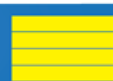

FÖRENKLAD MONTERINGSANVISNING.

(Visa steg är borttagna från ursprungskatalog)

K2R E

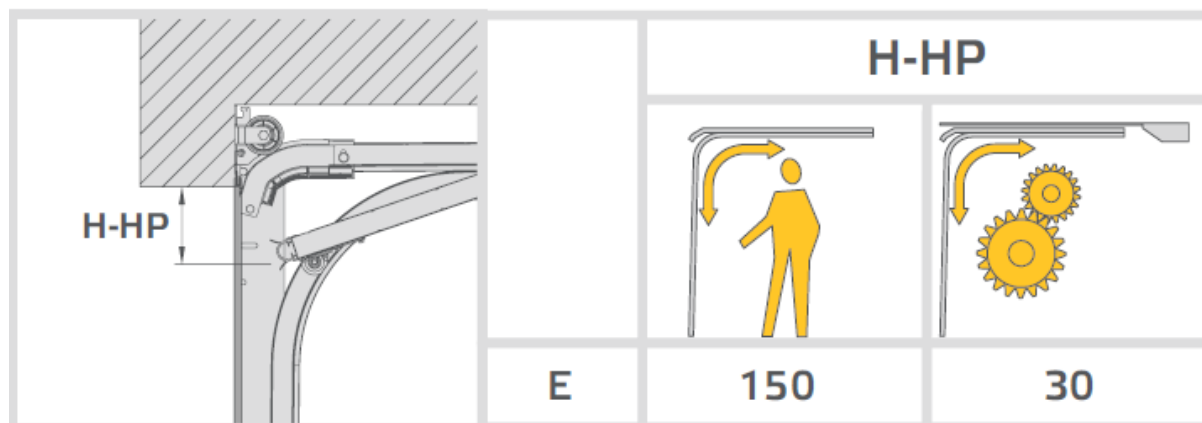
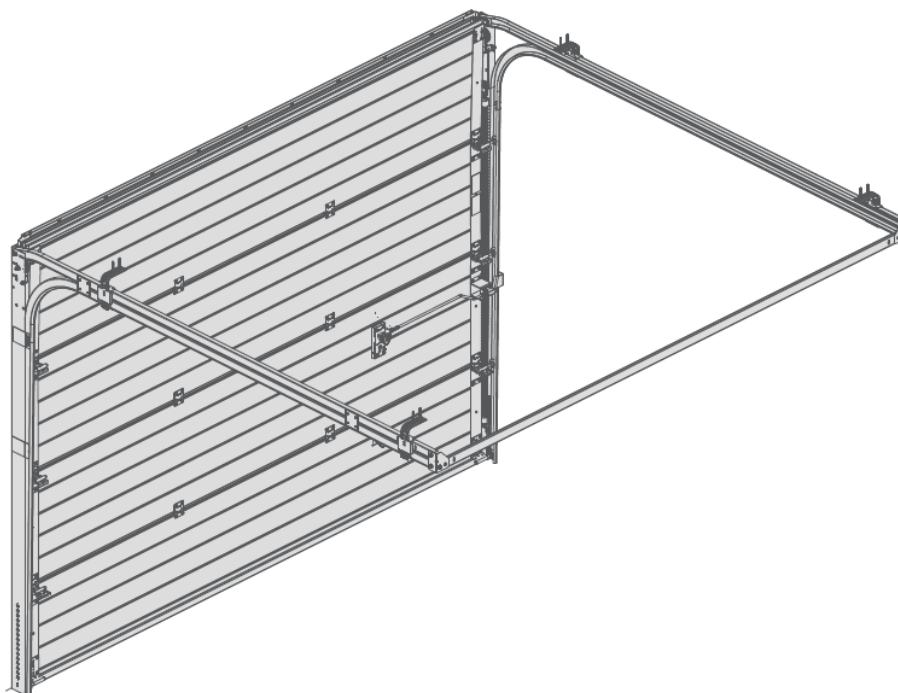



1

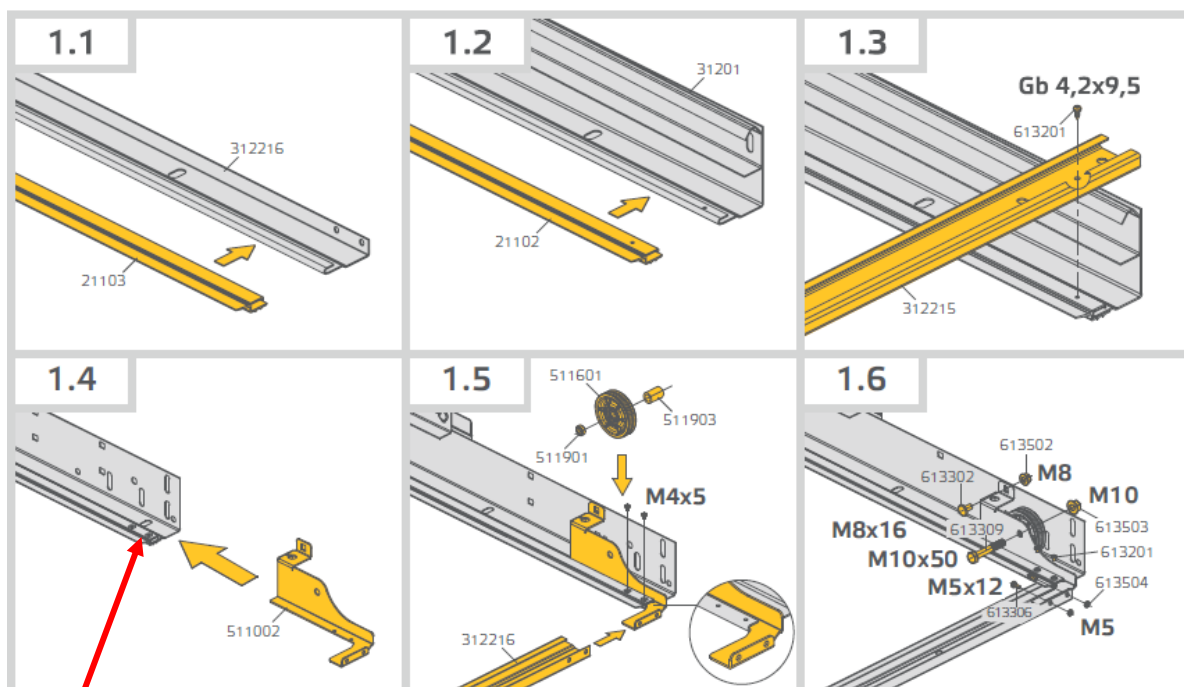
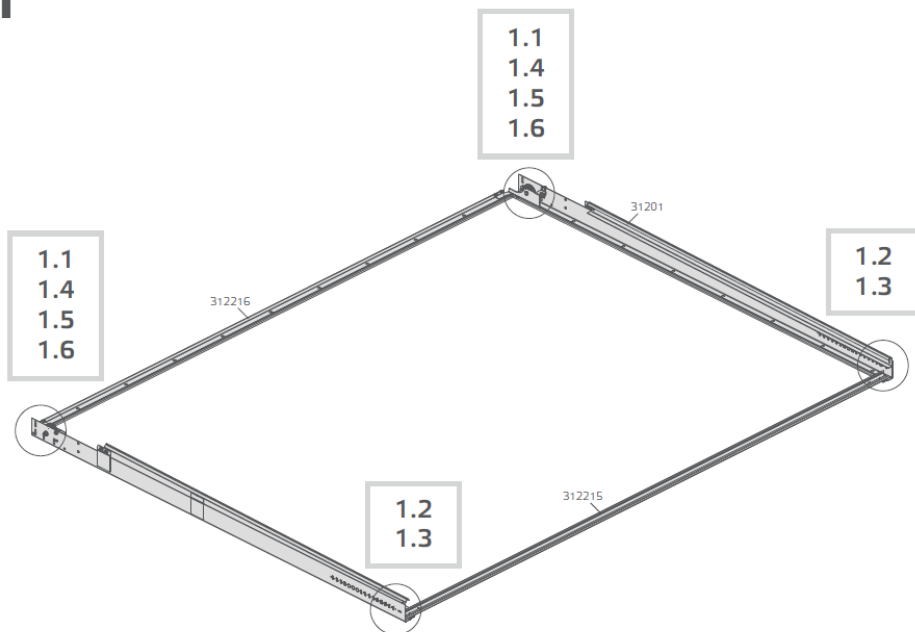

OBS!

Det Kan behövas att man böjer till i vecket i kanten innan man monterar konsolen!

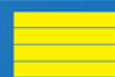



2

OBS!
Måste vara rakt.
Använd vattenpass.

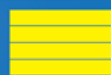
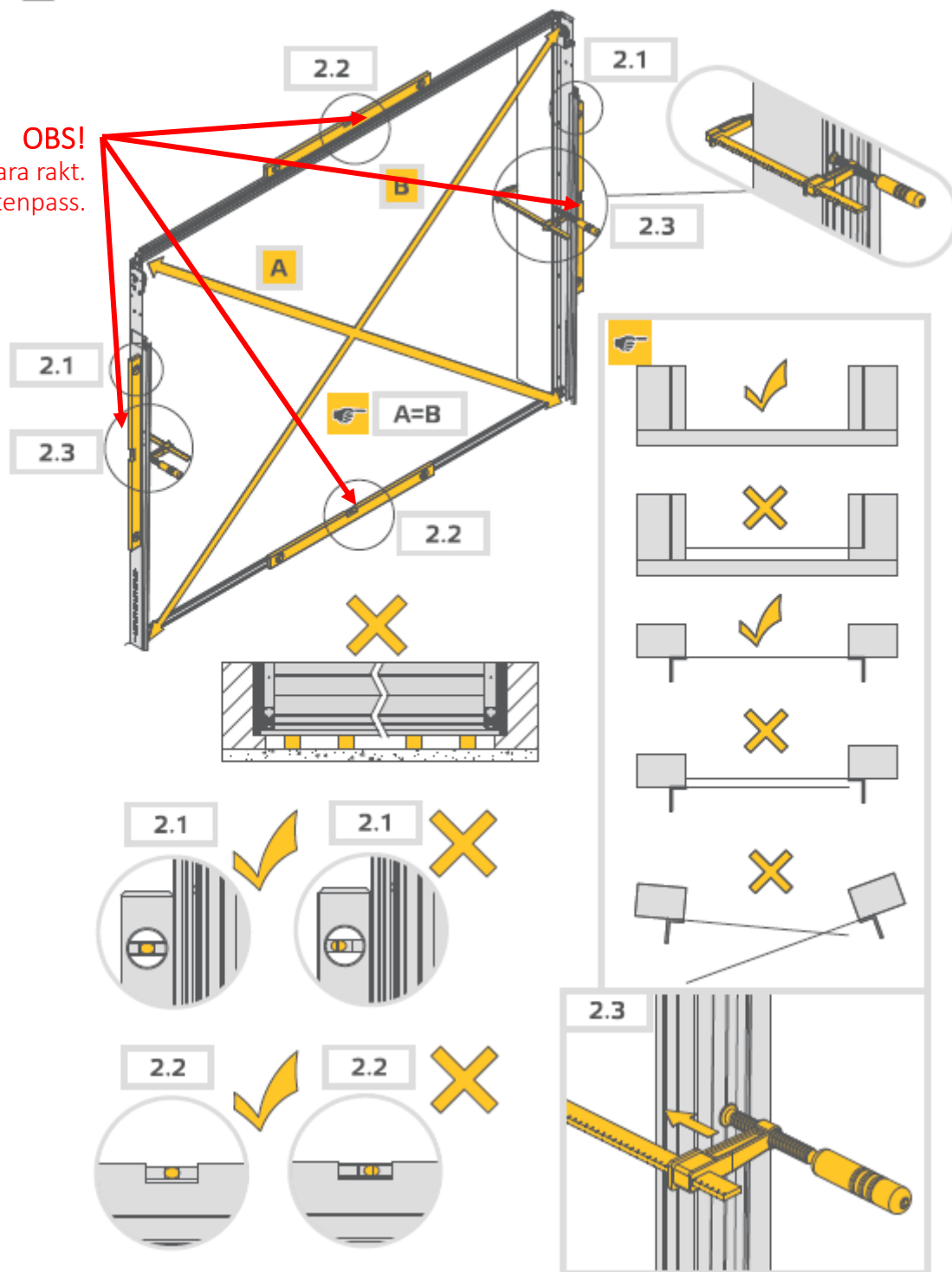

2

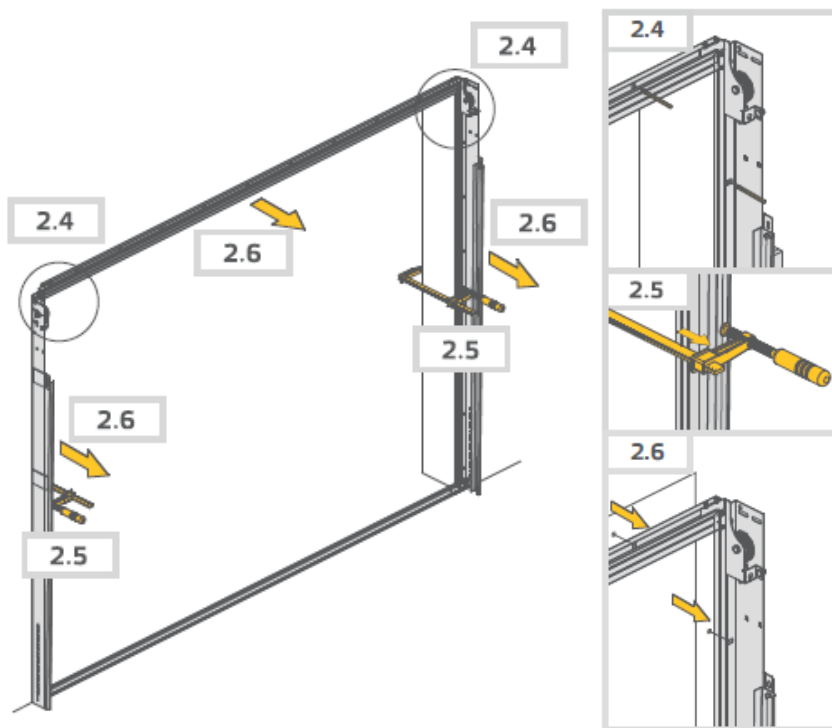

2

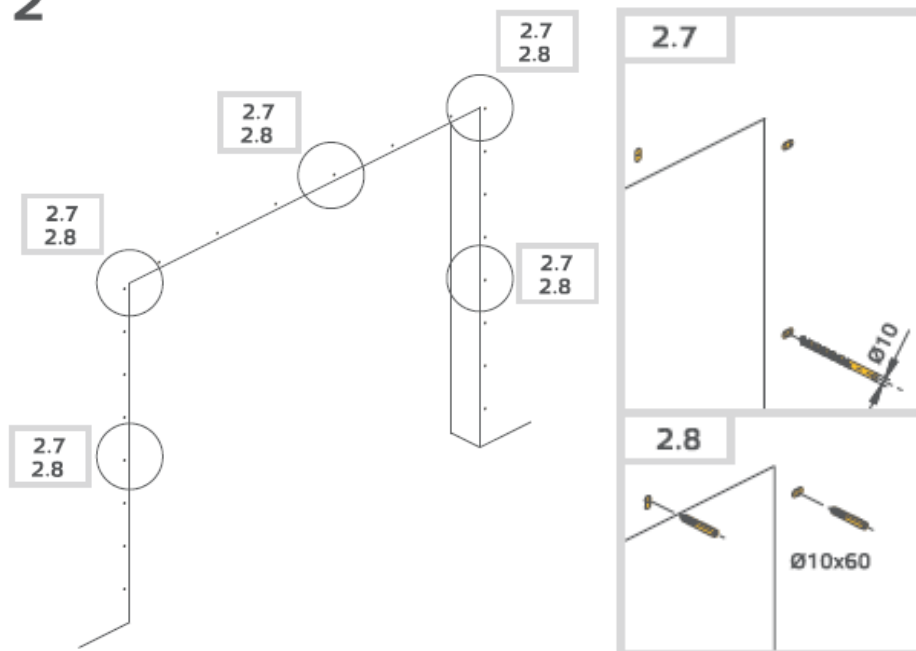



2

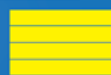
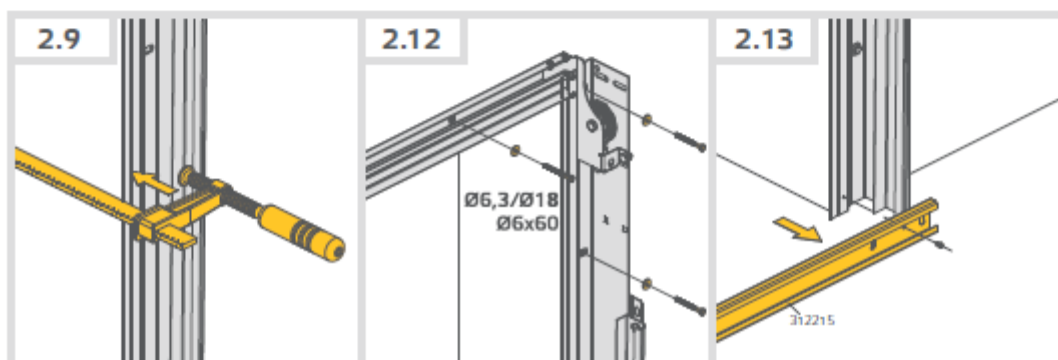
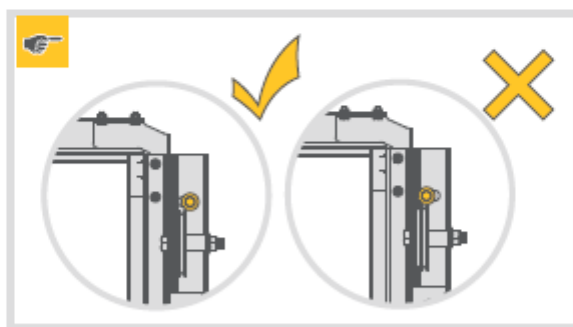
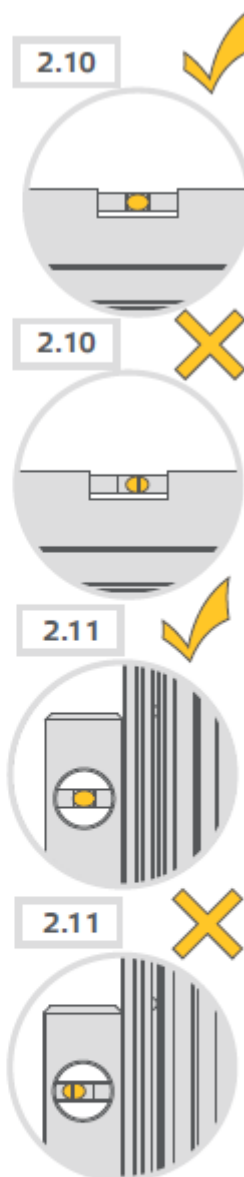
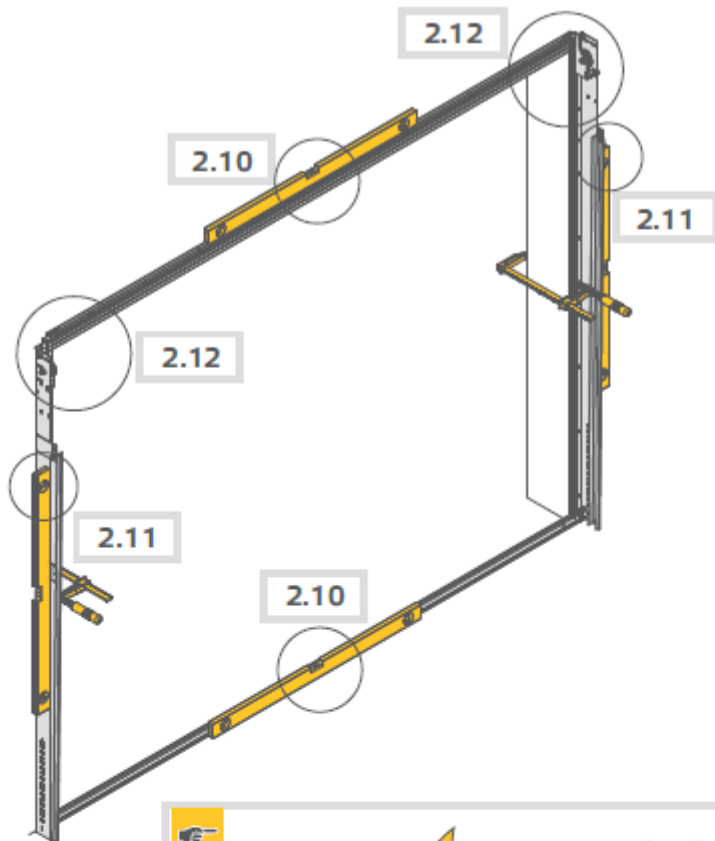



3

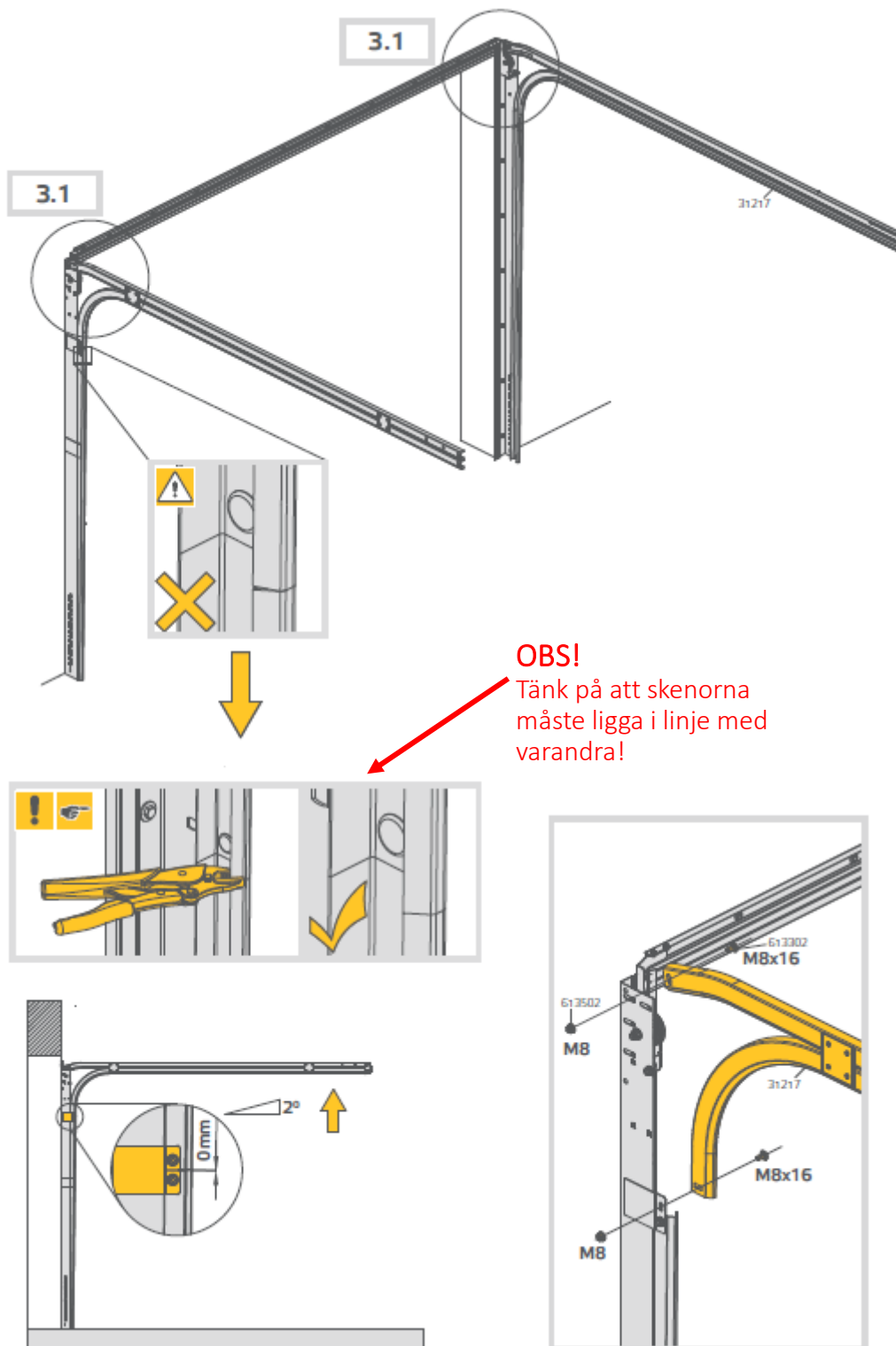

OBS!
Tänk på att skenorna
måste ligga i linje med
varandra!

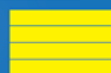



OBS!

Viktigt att kryssmättet är lika.
 Att alla skenorna är raka!

4

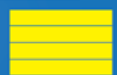
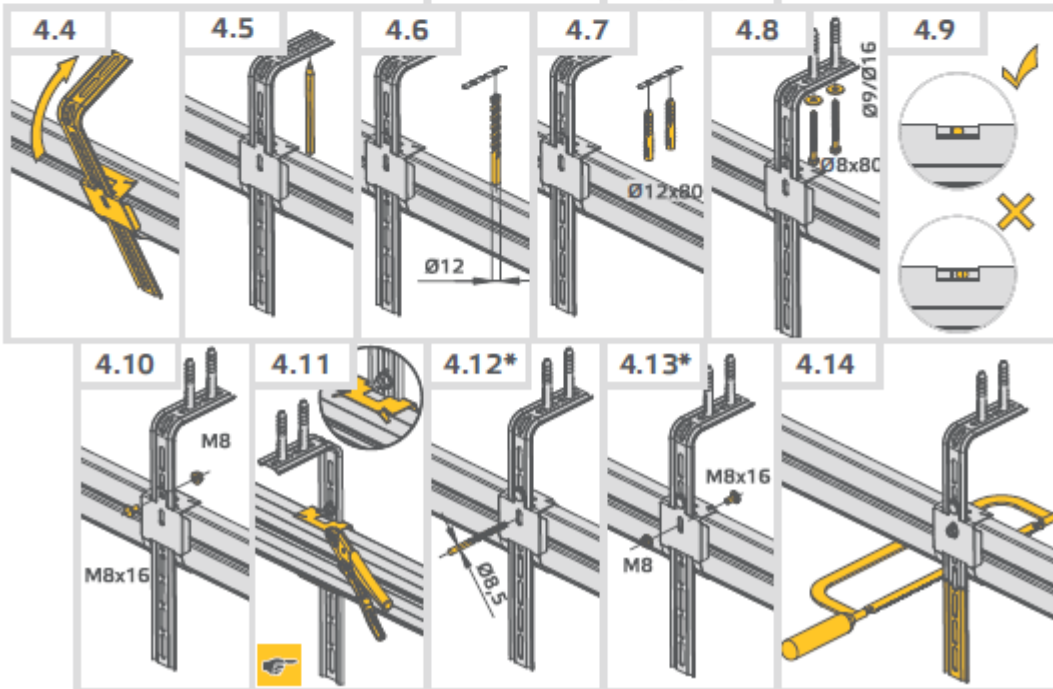
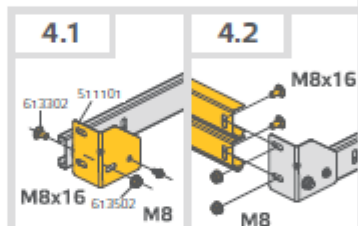
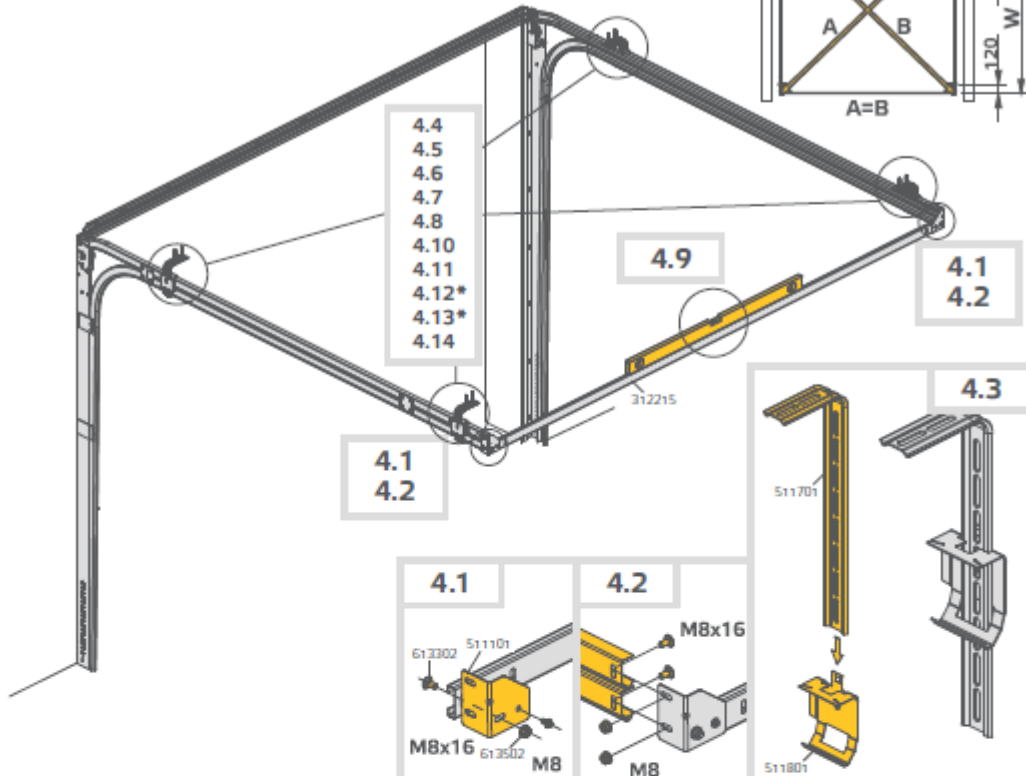
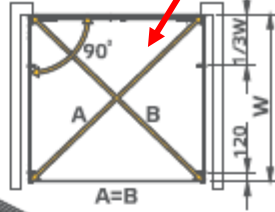



4* **i**

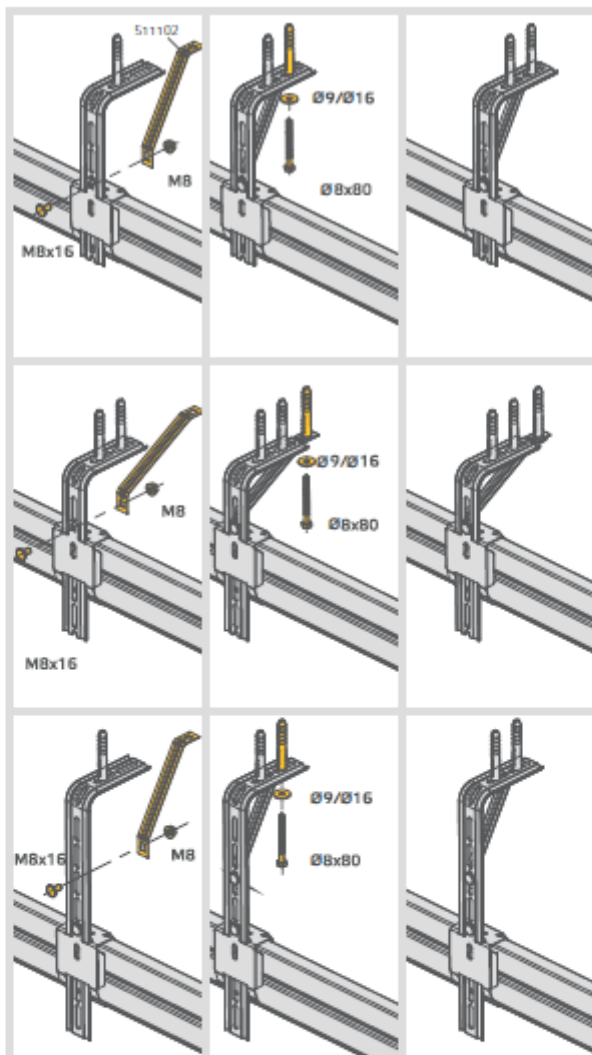

5*

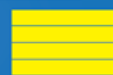
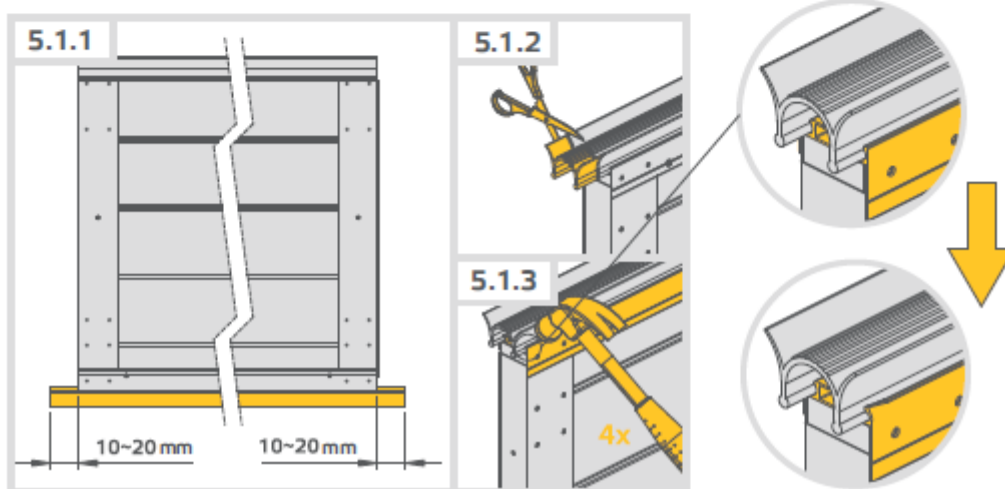



5

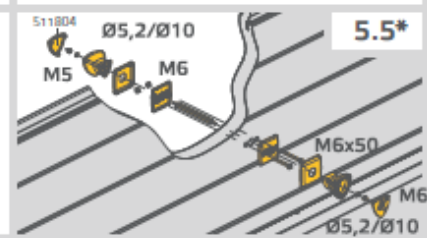
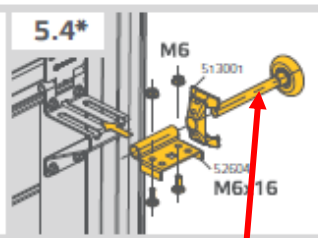
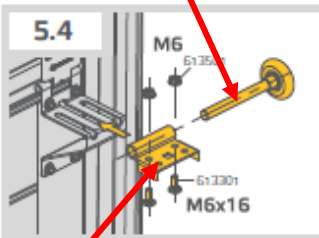
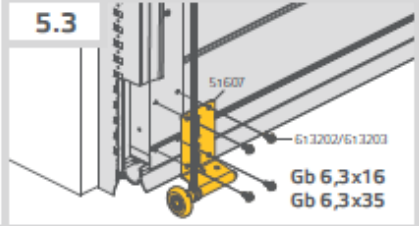
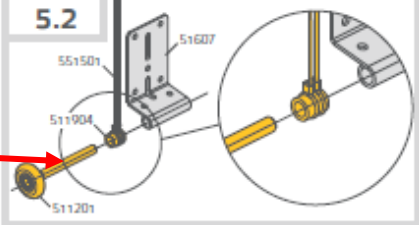
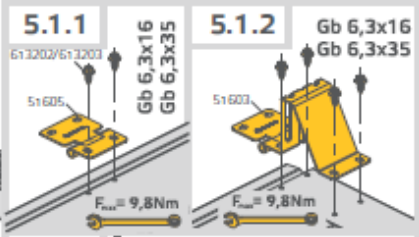
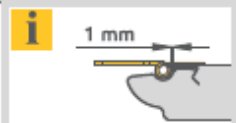
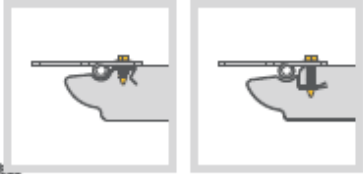
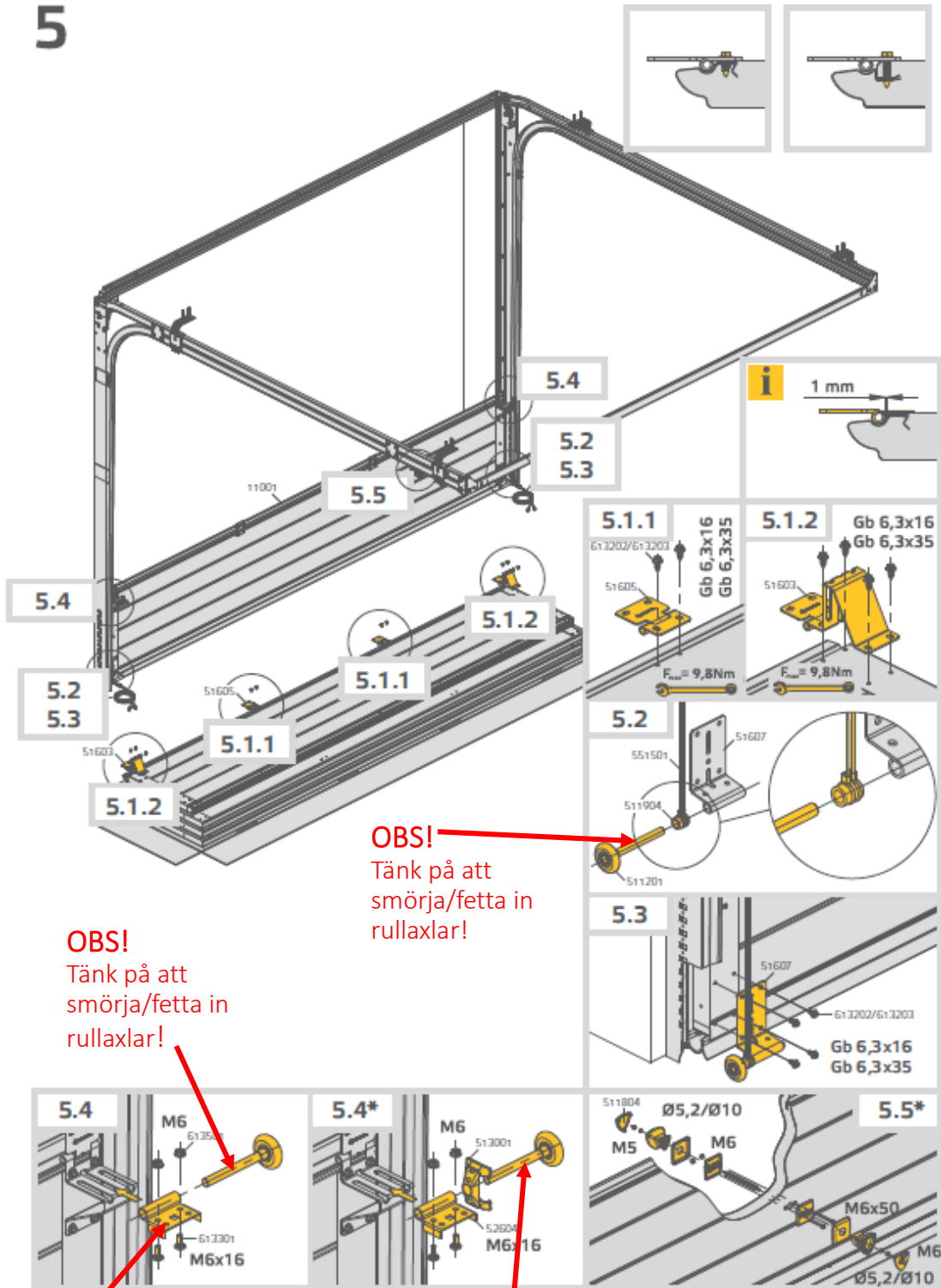

OBS!
 Tänk på att smörja/fetta in rullaxlar!

OBS!
 Tänk på att smörja/fetta in rullaxlar!

OBS!
 Tänk på att ha ett glapp mellan port blad & vägg på ca 5-10mm

OBS!
 Tänk på att smörja/fetta in rullaxlar!

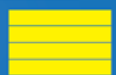



6

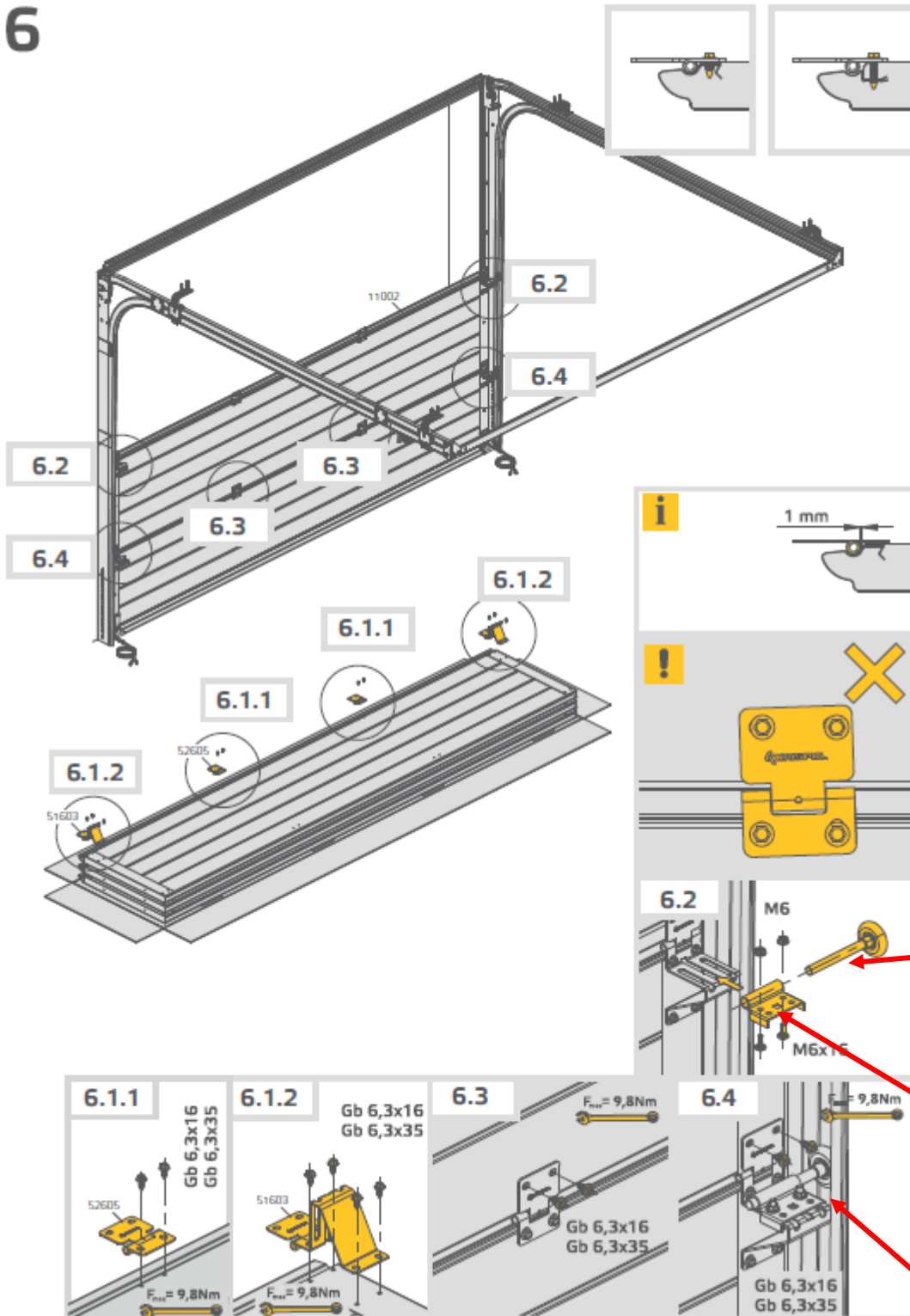

OBS!
Tänk på att smörja/fetta in rullaxlar!

OBS!
Tänk på att man kan behöva vända på överfallet på port blad 2 & 3

OBS!
Tänk på att ha ett glapp mellan port blad & vägg på ca 5-10mm

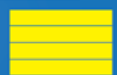



(Följande steg 7* gäller endast vid manuell portdrivning)

7*

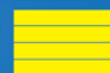
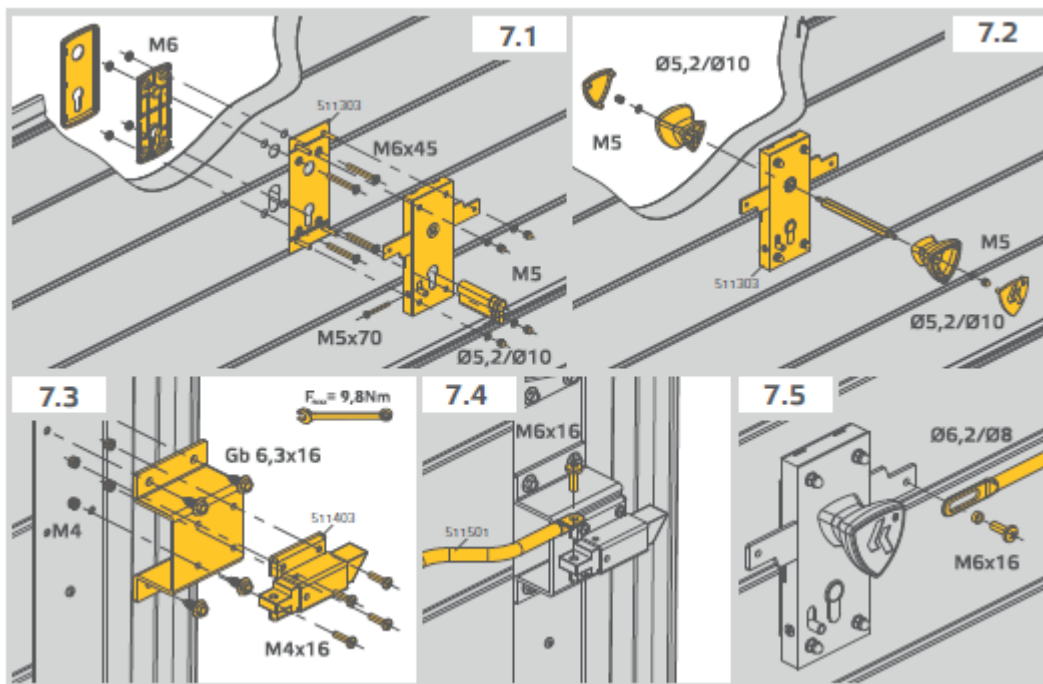
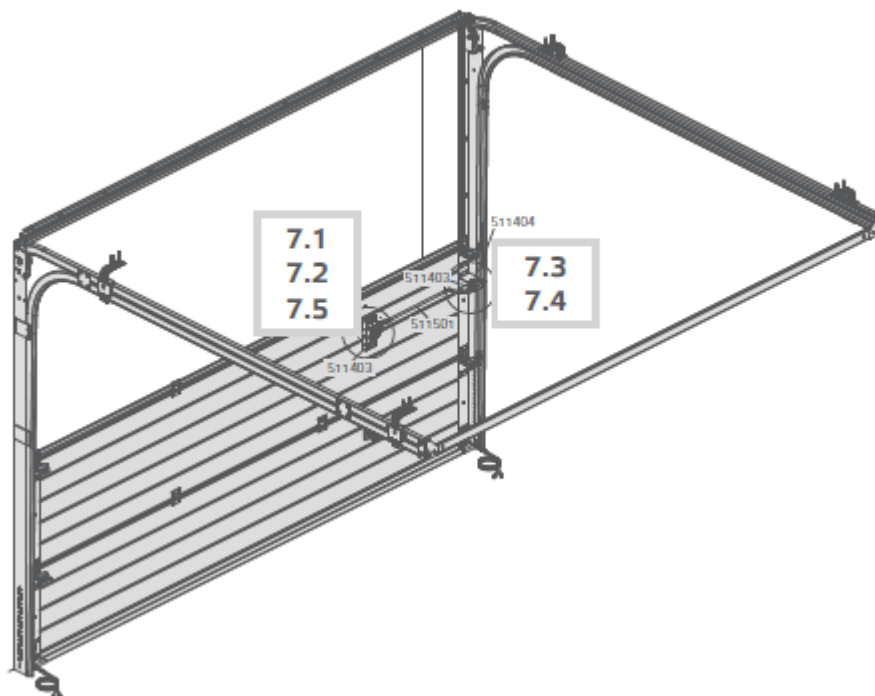



(Följande steg 8* gäller endast vid manuell portdrivning)

8*

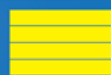
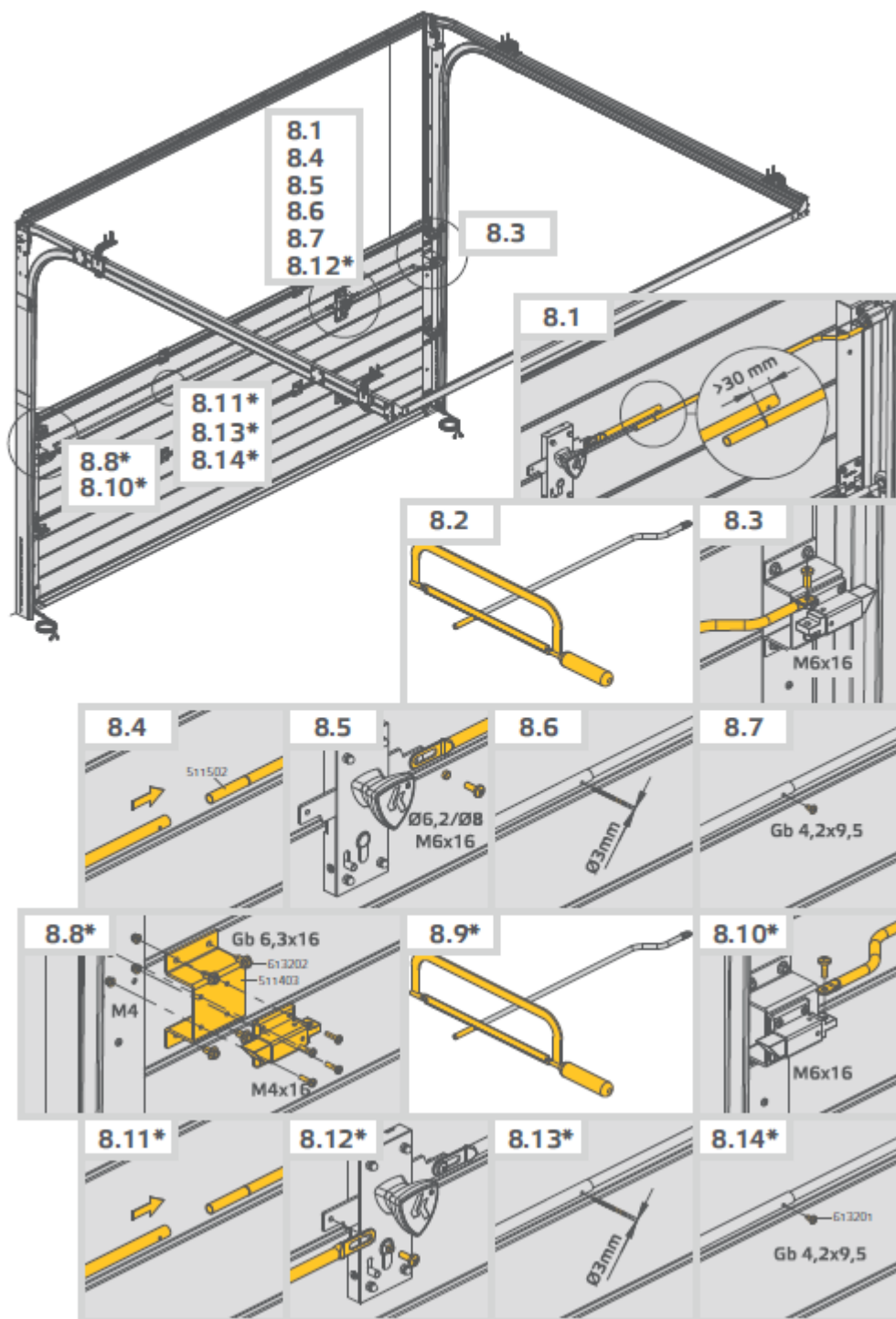



9

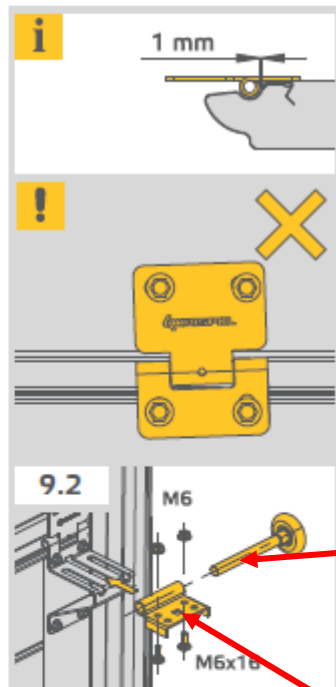
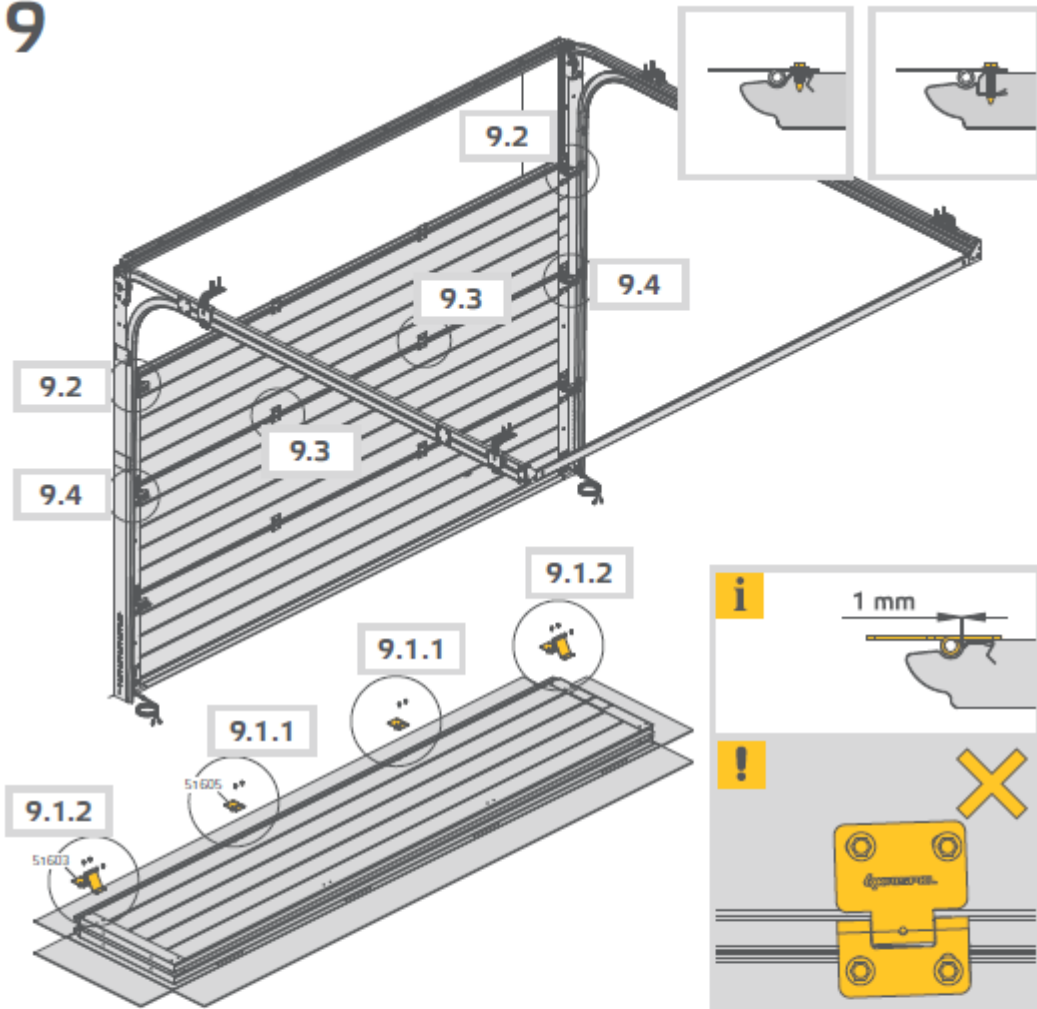

OBS!
Tänk på att smörja/fetta in rullaxlar!

OBS!
Tänk på att man kan behöva vända på överfallet på portblad 2 & 3

OBS!
Tänk på att ha ett glapp mellan portblad & vägg på ca 5-10mm

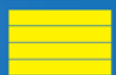
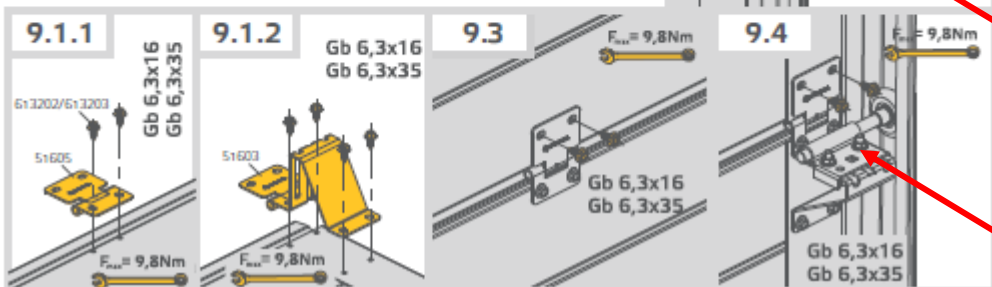



10

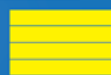
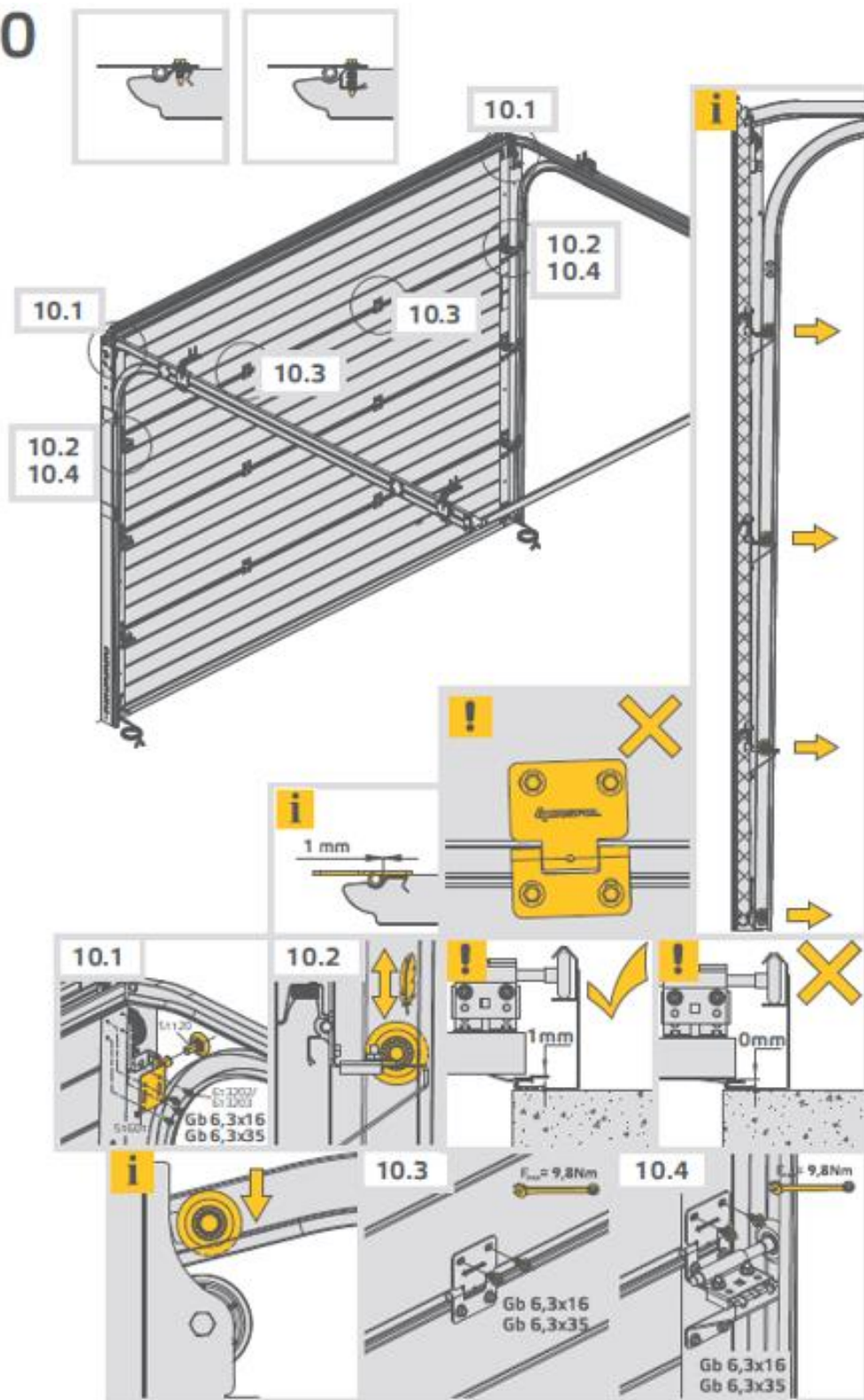



11

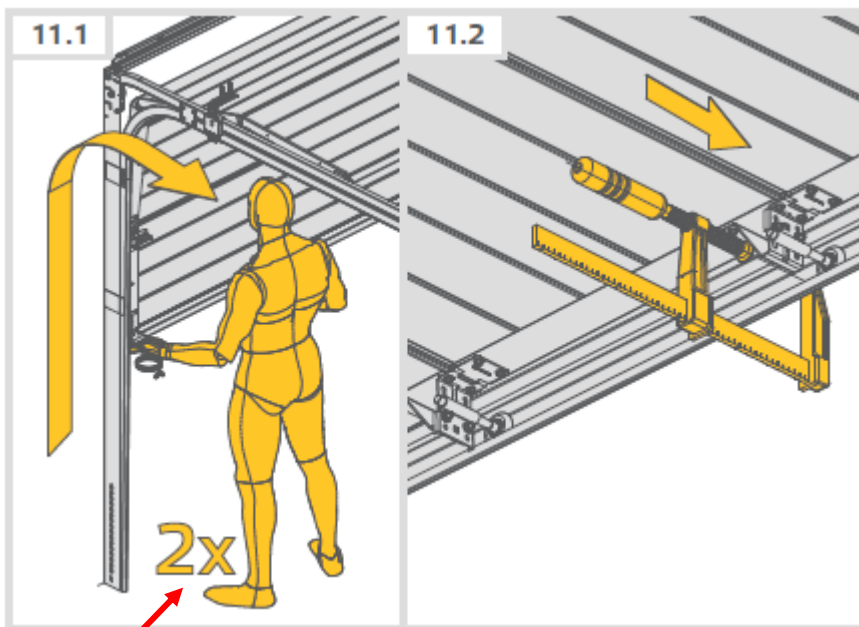
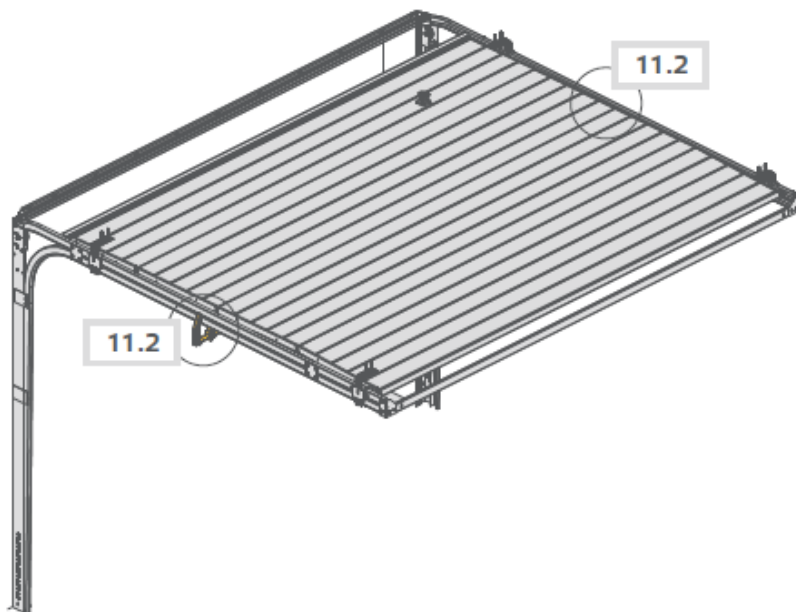

OBS!

Man kan behöva vara 2 stycken för att lyfta upp porten.

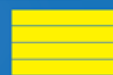



12

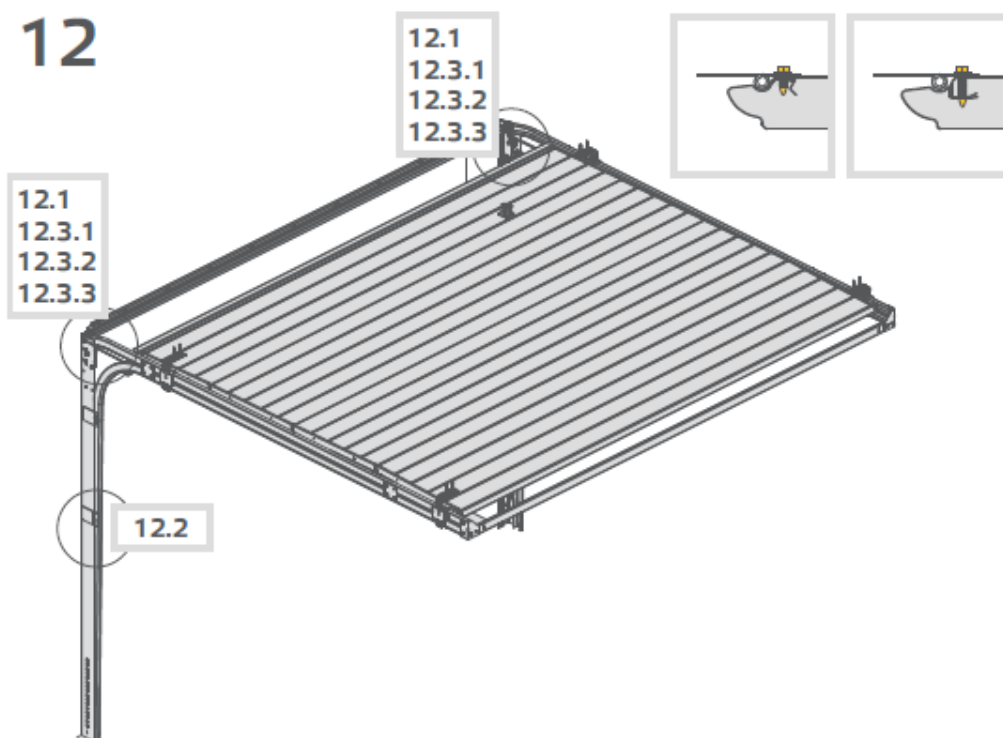

OBS!
Vajrarna får ej korsas!

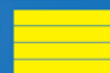
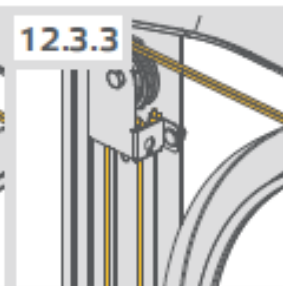
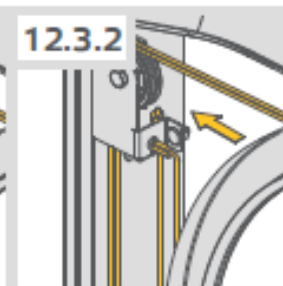
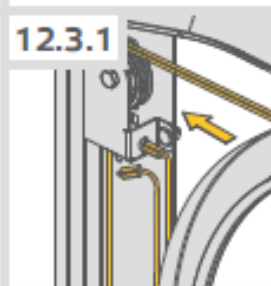
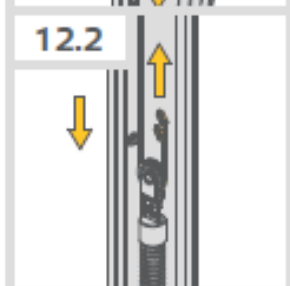
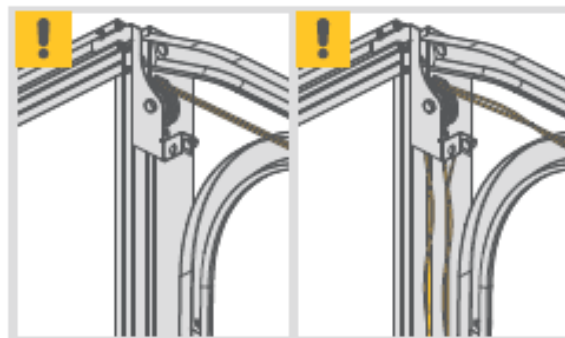
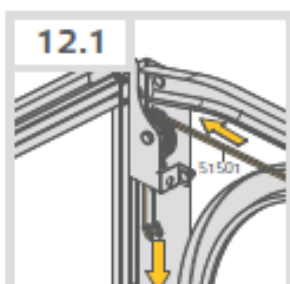



13

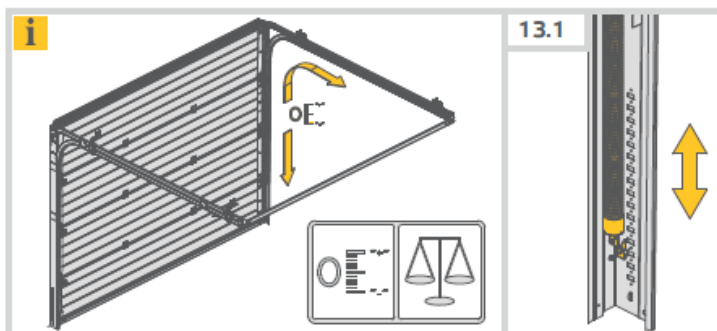
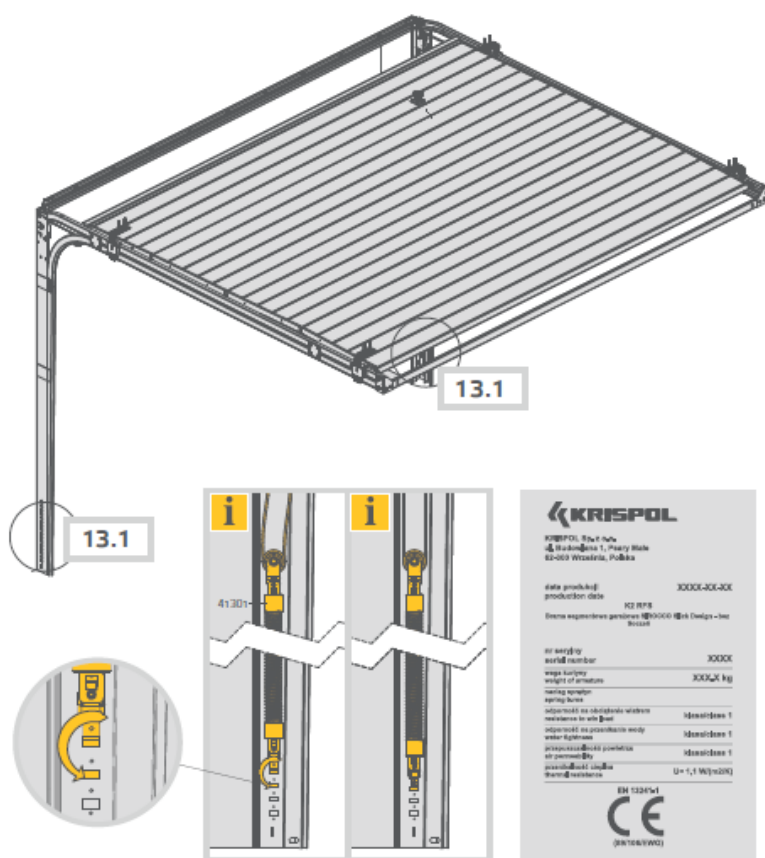

Enkelfjädr: Börja med håll 8a ned ifrån, porten ska vara jämt balanserad när nedersta port bladet är på ca 1 meter.

Dubbla fjädrar: Börja med 3e hålet ned ifrån, porten ska vara jämt balanserad när nedersta port bladet är på ca 1 meter.

Man kan behöva justera fjädrarna upp & ner beroende på om porten är obalanserad. Fjädrarna måste sitta på samma håll/höjd på varje sida.

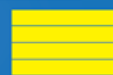

(Nedan steg 14* gäller endast vid manuell portdrivning!)

14*

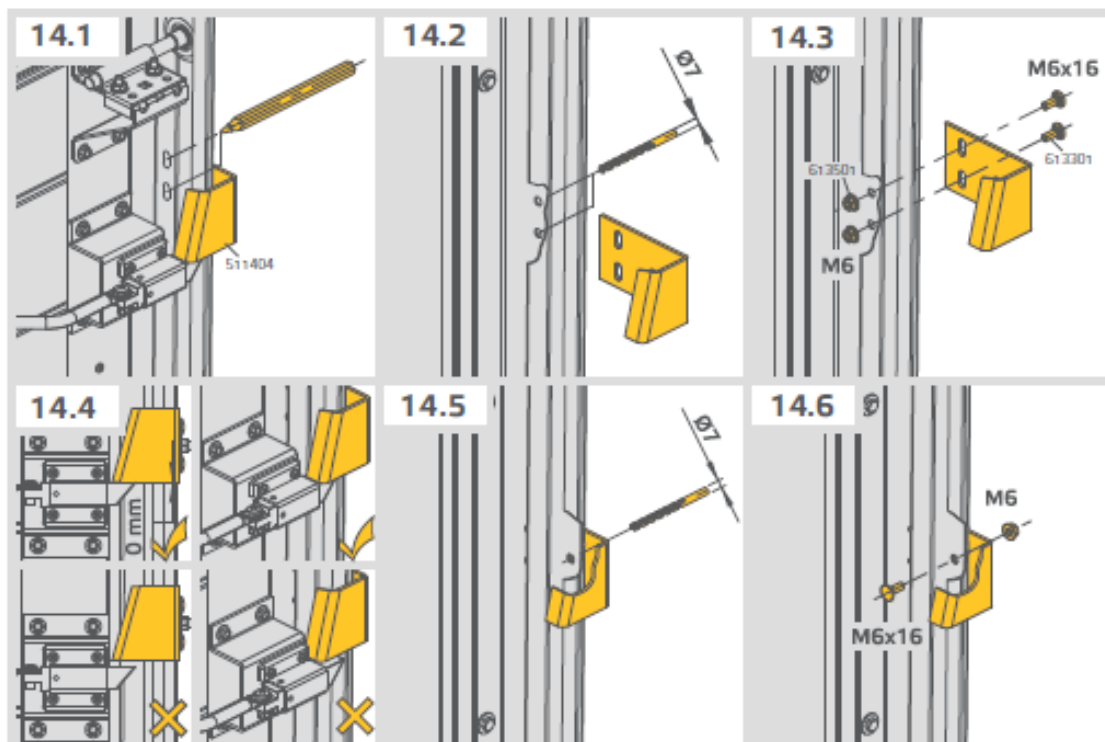
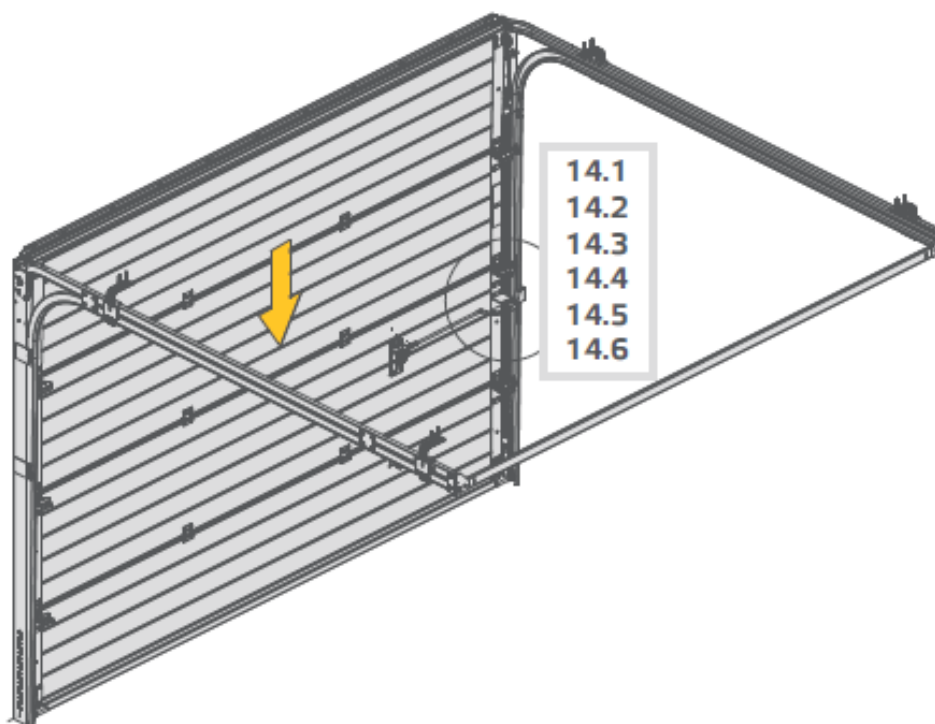

(Nedan steg 15* gäller endast vid manuell portdrivning!)

15*

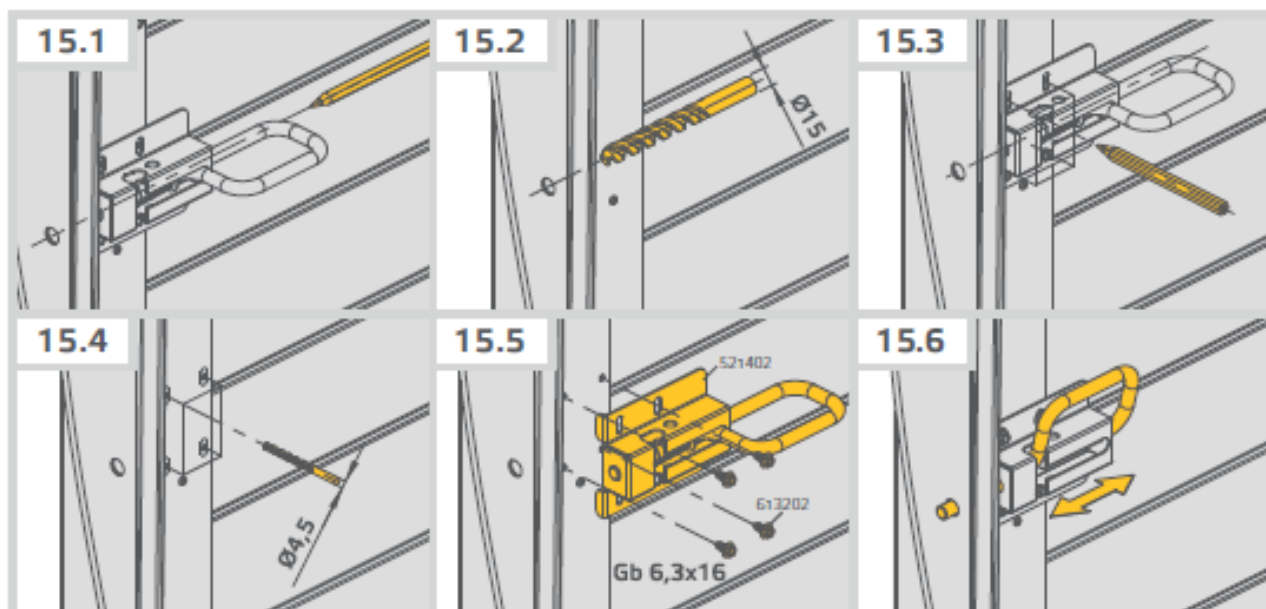
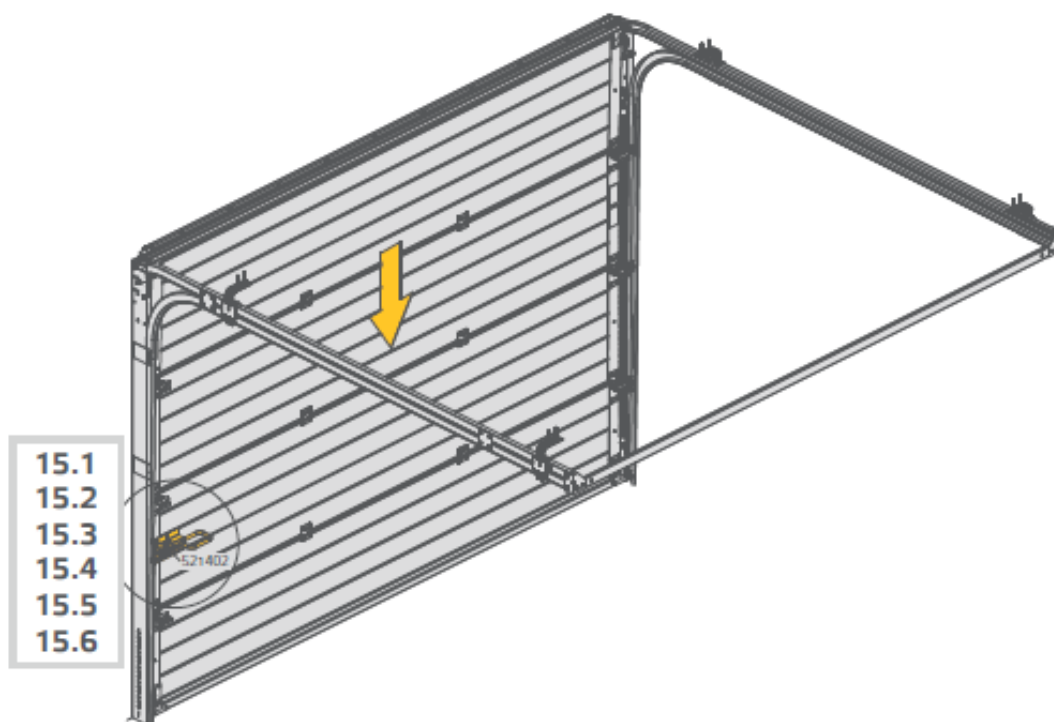



16*

